

INSTALL DIAGONAL ROWS BI-DIRECTIONAL YELLOW RRPMS BETWEEN EVERY SECOND CHEVRON. PROVIDE 100mm GAP BETWEEN RRPMS. FACE OF RRPMS TO BE NORMAL TO DIRECTION OF TRAVEL. FLUSH MEDIAN IS TYPICALLY USED ON THE APPROACH TO AN OBSTRUCTION THAT IS OVER A CREST OR IN AREAS OF POOR SIGHT DISTANCE

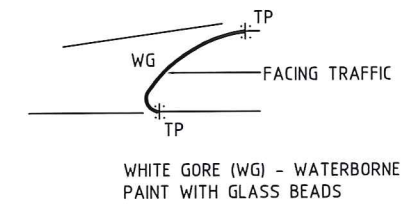
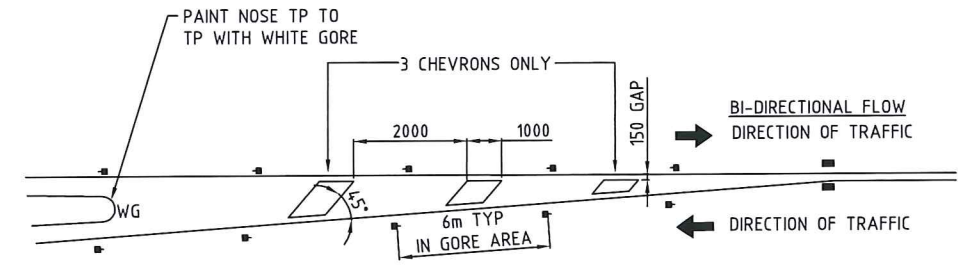

NOTES

- FOR TRIANGULAR ISLANDS WITH EACH SIDES $\leq 5\text{m}$ ALL KERB LENGTHS TO BE PAINTED WITH WHITE GORE (WG)
- FOR PEDESTRIAN ISLANDS $\leq 10\text{m}$ LENGTH ALL KERB LENGTHS TO BE PAINTED WITH WHITE GORE (WG)
- UNLESS APPROVED OTHERWISE ALL LETTERING SHALL BE IN ACCORDANCE WITH AS1742.2

NOTE

ALL DIMENSIONS SHOWN ARE IN mm UNLESS SHOWN OTHERWISE

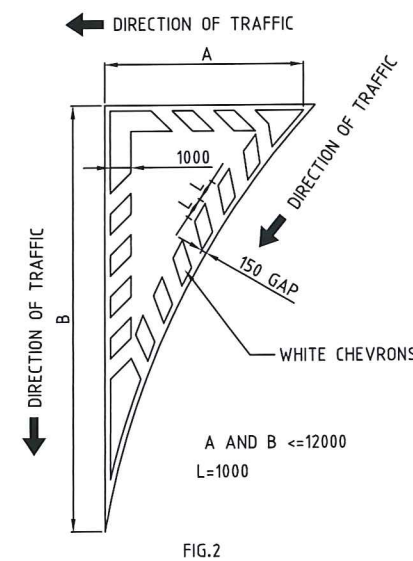
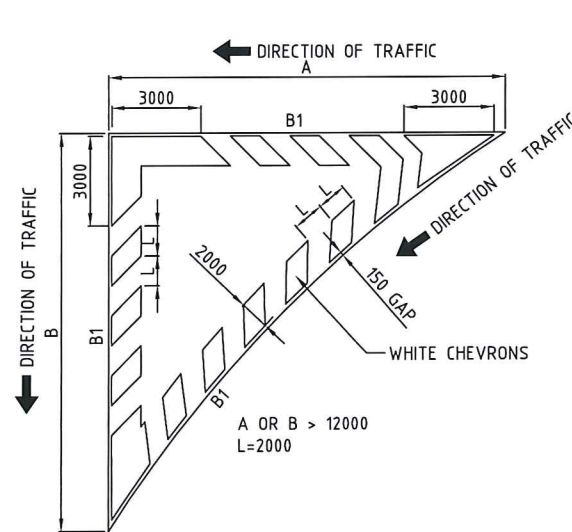

TYPICAL TREATMENT - PAVEMENT MARKING FOR CHEVRONS
REFER TO AS.1742 PART 2 FOR RRPMS SPACING.

 ACT GOVERNMENT DESIGN STANDARD URBAN INFRASTRUCTURE	
Authorised: DIRECTOR, ROADS ACT TONY GILL	<i>TG</i> <i>23/06/11</i>
Drawn: MARTIN GORDON	Date 23/06/2011
Project Engineer: FRED IHEGIE / SNEZANA DIMITROVSKA	Date 23/06/2011
MISCELLANEOUS LINEMARKING DETAILS	
Scale NTS	Date 23 JUNE 2011
AutoCAD File DS9-05.DWG	
Latest Revision Details A REVISIONS DUE TO UPDATE OF AS1742.2	
Drawing No. DS9-05	Revision A