

Margaret Timpson Park Upgrades Landscape Plan

KEY

Extent of Works

Offsets

EXISTING ELEMENTS

- Existing Drinking Fountain**
Drinking fountain to be retained
- Existing Pedestrian Crossing**
Pedestrian crossing over Benjamin Way, connecting the Belconnen Mall to Margaret Timpson Park
- Existing On-street Parking**
Loading zones, taxi zones, disabled and regular hour limit parking along Benjamin Way and Chandler Street
- Existing Grass Mound**
Retained existing grass mound
- Existing Seating**
Retained existing seating
- Existing Bins**
Existing bins to be retained
- Existing Art Installation**
Existing Art sculpture to be retained
- Park Entry Arch**
Existing landmark entry structure

PROPOSED ELEMENTS

- Pedestrian Path**
New path providing pedestrian access
- Accessible Ramp**
Accessible ramp to provide northern access from Chandler Street
- Public Toilet**
Site identified for single accessible cubicle toilet block
- Play Space Area with Softfall Rubber**
Hero piece Rope Pyramid, Springer, Tower Rope Spinner and Basket swing
- Picnic Area**
Picnic area with accessible table setting
- BBQ**
Electric BBQ
- Maintenance Access Upgrade**
Proposed maintenance access upgrades
- Proposed Trees**
New design trees
- Proposed Informal Seating**
Sandstone block seat

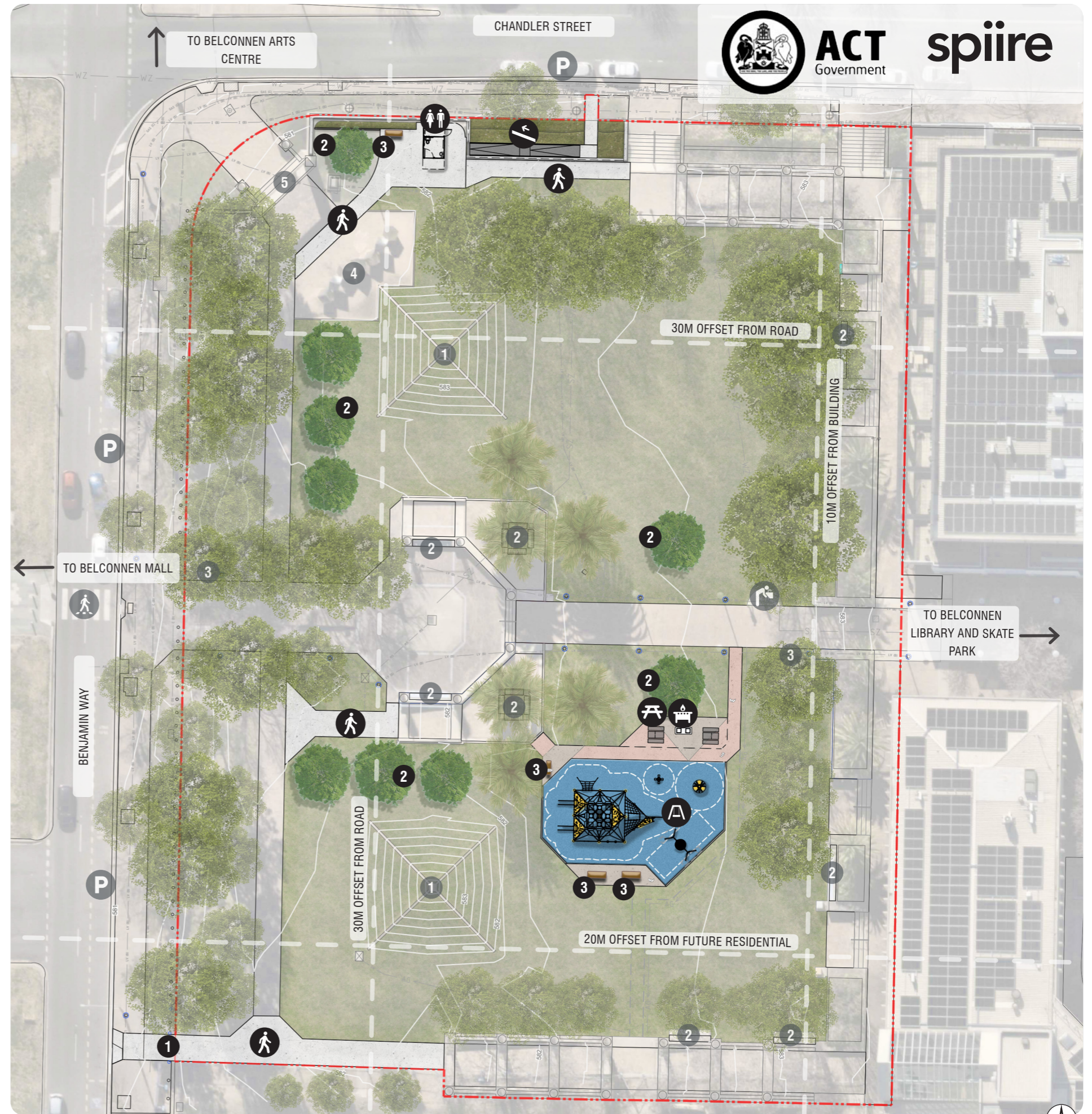

ACT
Government

spiire



Margaret Timpson Town Park Upgrades

Landscape Elevation Through Play Space



spiire

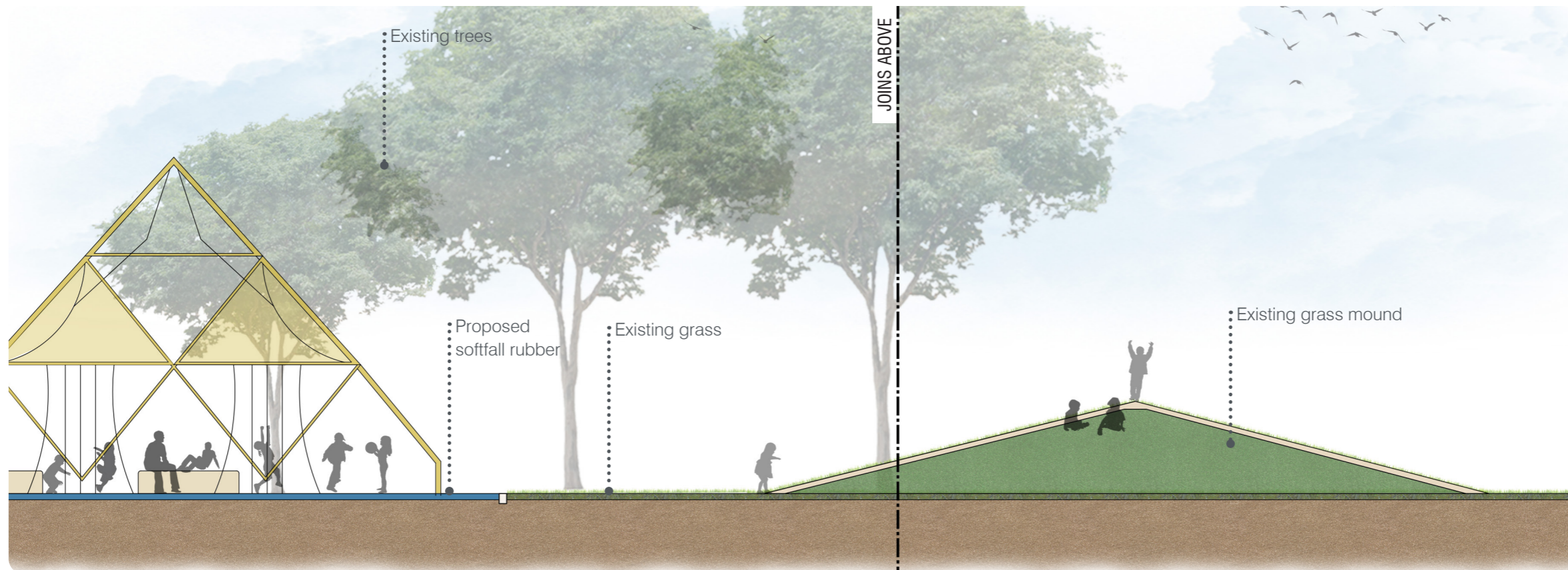
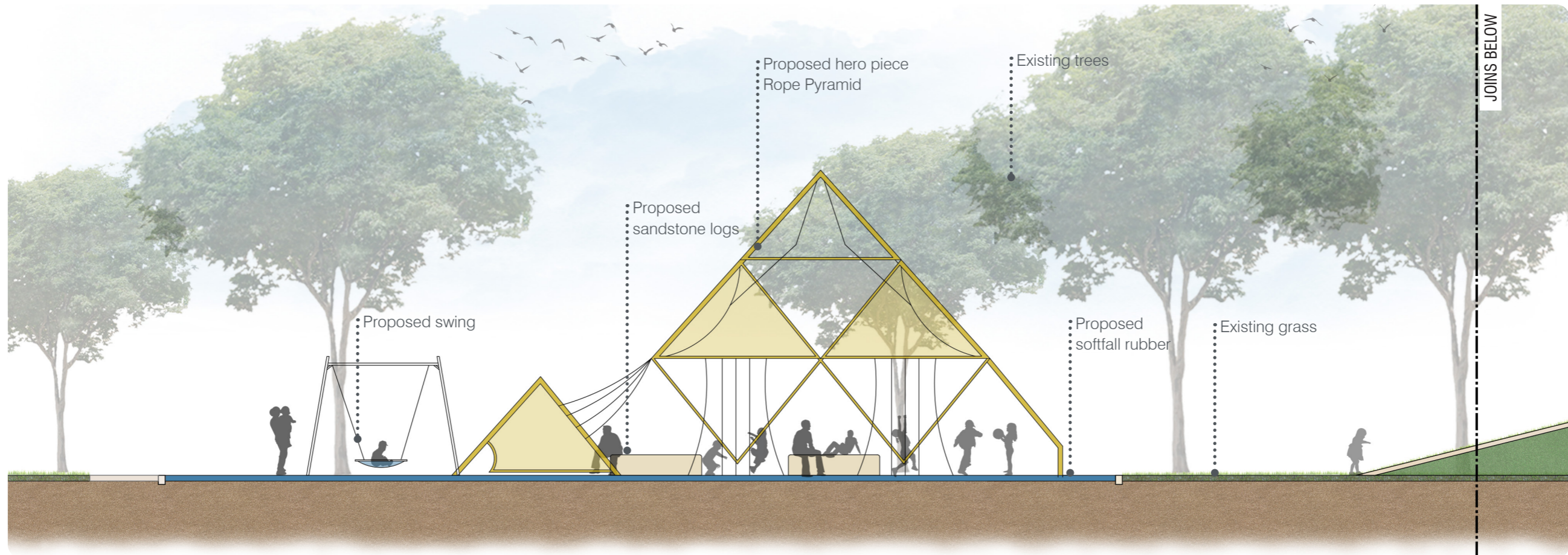

Margaret Timpson Town Park Upgrades

Landscape Elevation Through Toilet Block and Access Ramp



spiire

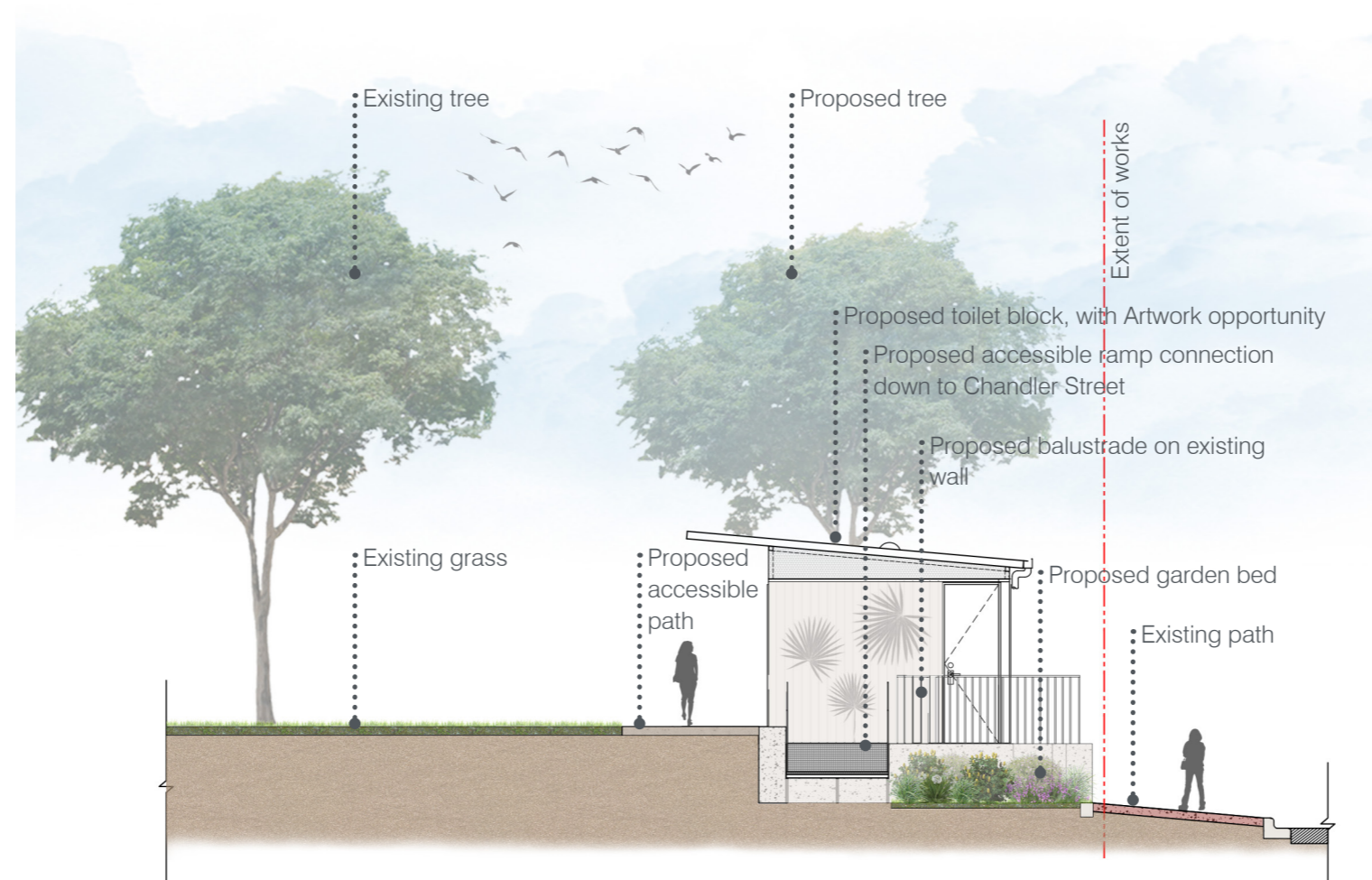

Margaret Timpson Town Park Upgrades

Proposed Indicative Materials and Equipment



ACT
Government

spiire

PROPOSED PLAY EQUIPMENT

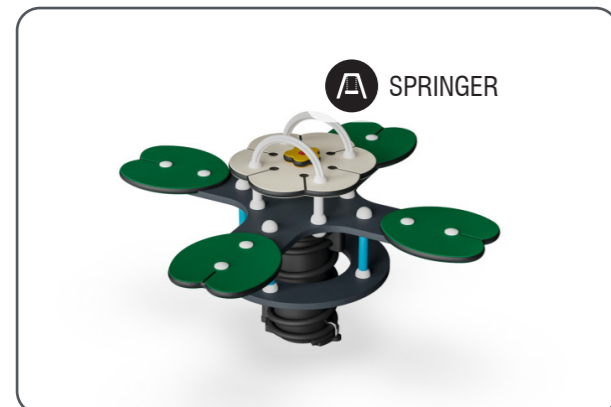
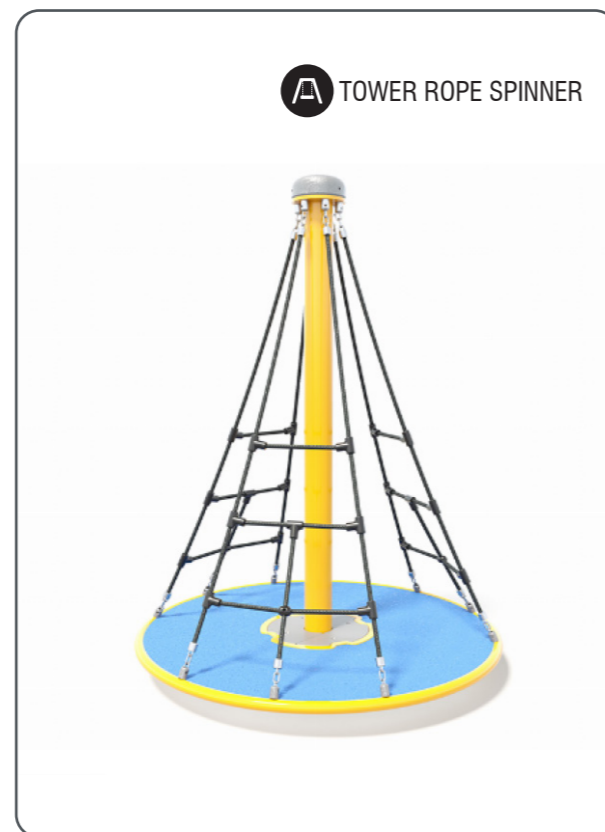
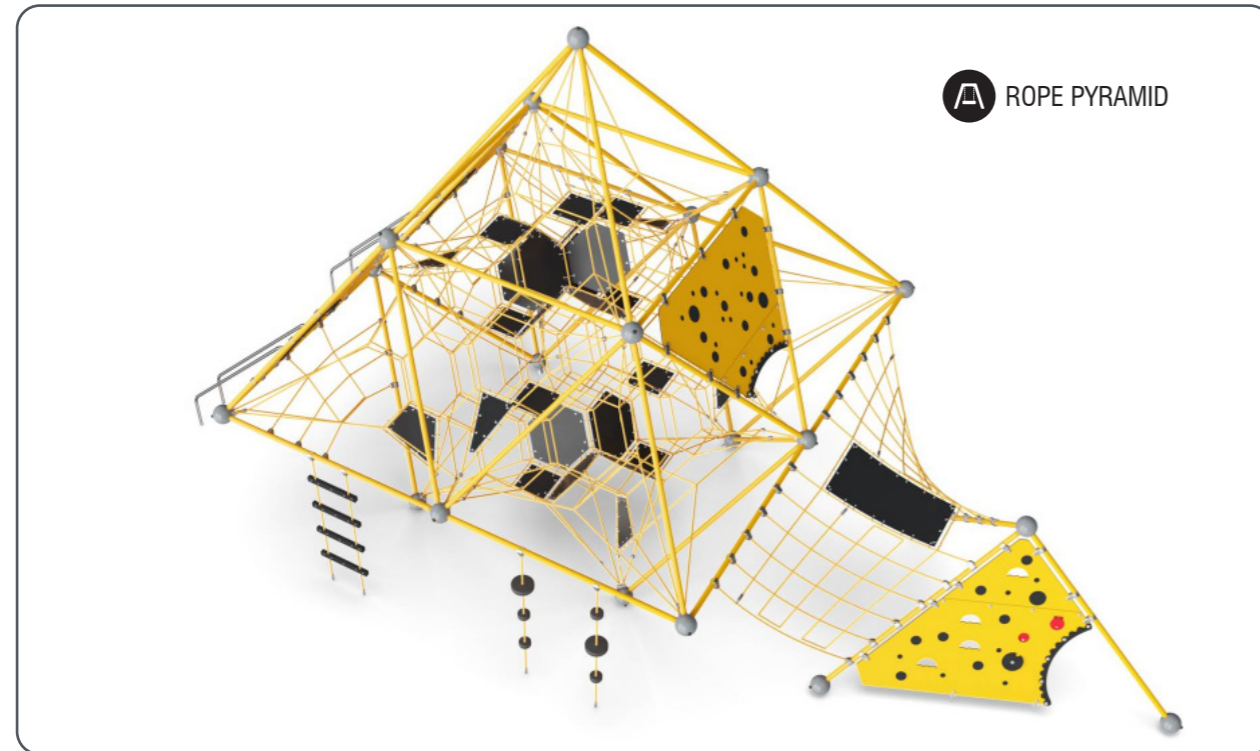

INDICATIVE FURNITURE AND AMENITY

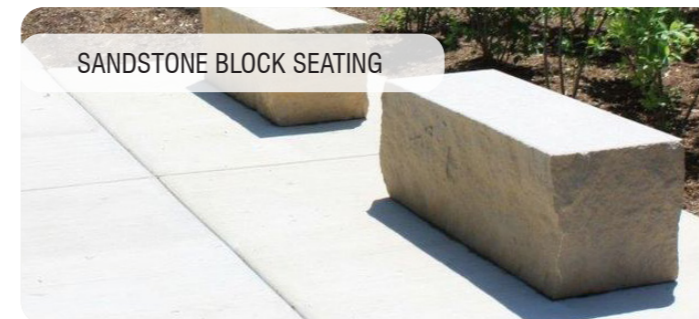

INDICATIVE FINISHES

