

DRIVEWAY TYPE R ≤ 3 DWELLINGS

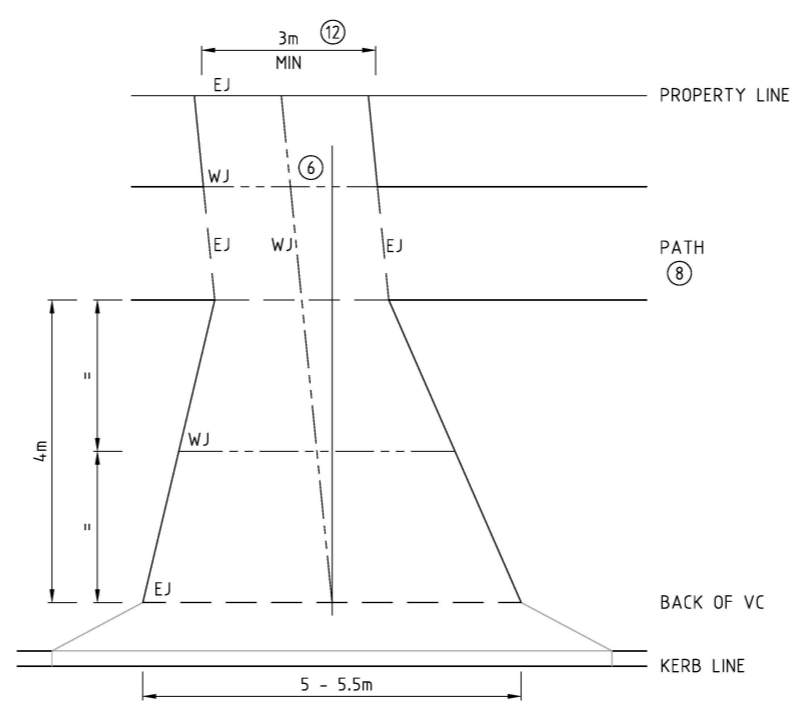

DRIVEWAY TYPE R - SKEWED

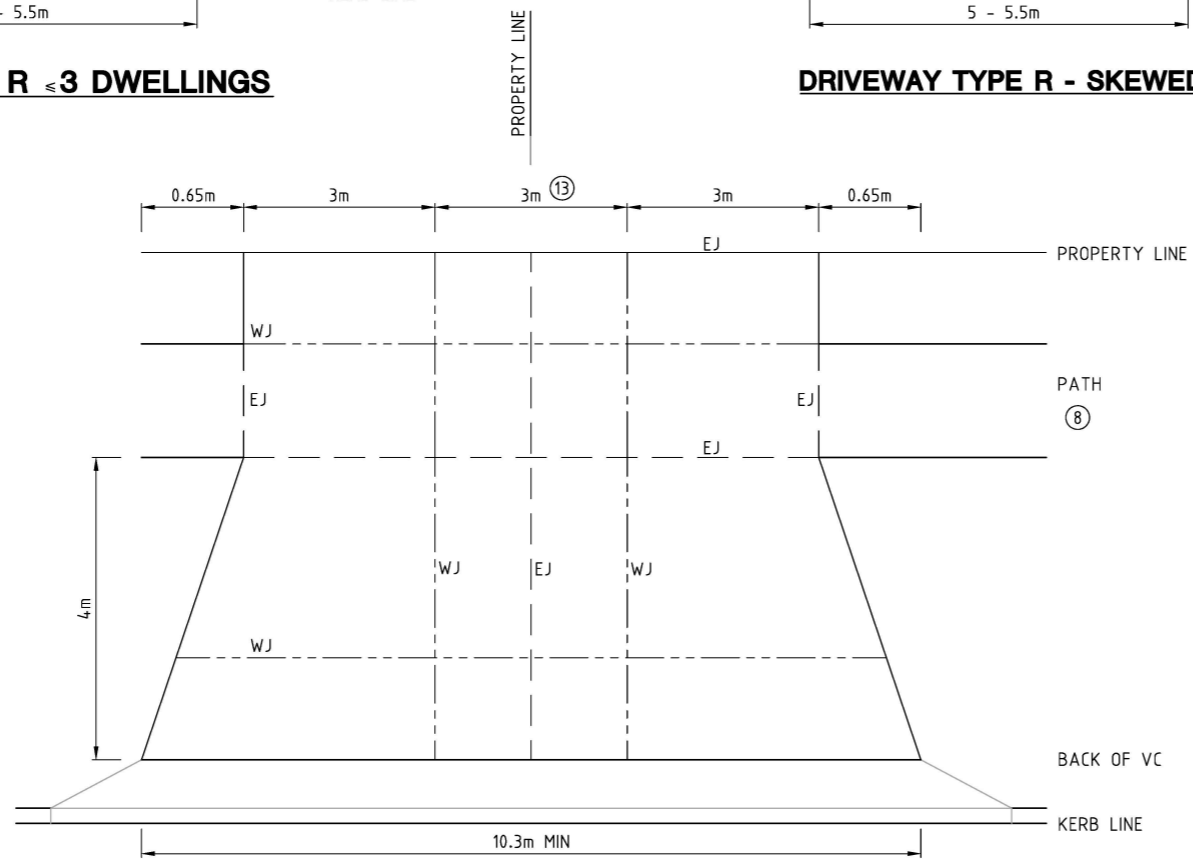

DRIVEWAY TYPE R DOUBLE

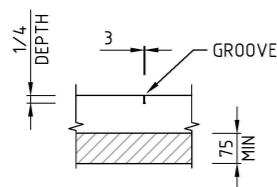

WEAKENED PLANE JOINT "WJ"

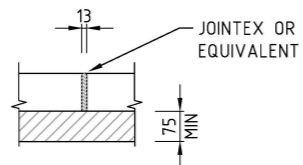

EXPANSION JOINT "EJ"

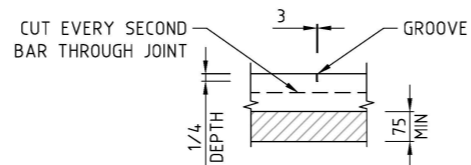

WEAKENED PLANE JOINT "WJ" WITH REINFORCEMENT

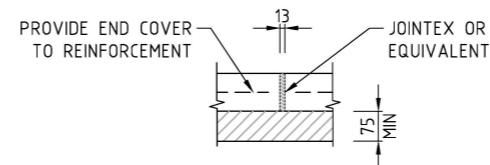

EXPANSION JOINT "EJ" WITH REINFORCEMENT

JOINT DETAILS

NOTES:

1. REFER TO DRAWING ACTSD-0000 FOR GENERAL NOTES.
2. REFER TO DRAWING ACTSD-0702 FOR DRIVEWAY TYPES.
3. REFER TO MIS07 FOR DRIVEWAY CLEARANCES TO OTHER INFRASTRUCTURE.
4. DRIVEWAYS SHALL BE CONSTRUCTED WITH GRADE N32 TO MITS06B.
5. DRIVEWAYS SHALL BE CONSTRUCTED ON DGS20 MIN 75mm THICK TO MITS04 AND COMPACTED TO 100% SDD. SUBGRADES SHALL BE COMPACTED 95% SDD.
6. DRIVEWAY CENTERLINE TO BE CONSTRUCTED PERPENDICULAR TO KERBLINE WHEREVER POSSIBLE. MAX SKEW OF 1:10 IS PERMITTED.
7. DOMESTIC DRIVEWAYS ARE APPLICABLE FOR UP TO 3 RESIDENCES. FOR ACCESS TO MORE THAN 3 RESIDENCES, HEAVY DUTY DRIVEWAYS SHALL BE USED. SEE DRAWING ACTSD-0702.
8. PATH THROUGH DRIVEWAYS TO BE CONSTRUCTED AS PER DRIVEWAY. PATH GRADING, ALIGNMENT AND FINISH SHALL APPEAR CONTINUOUS WITH OTHER PATH SECTIONS.
9. EXISTING PATHS ACROSS PROPOSED DRIVEWAYS ARE TO BE REMOVED AND REPLACED WITH DRIVEWAY PAVEMENT UNO.
10. BROOM FINISH TO BE APPLIED TO ALL DRIVEWAY SURFACES.

DOMESTIC DRIVEWAYS:

11. DOMESTIC DRIVEWAYS SHALL BE MIN 100mm THICK AND UNREINFORCED UNO.
12. MAX WIDTH NOT GREATER THAN WIDTH AT KERB. WIDTH > 3m WILL ONLY BE SUPPORTED FOR MULTIPLE CAR GARAGE OR MULTIPLE DWELLINGS.
13. WHERE DOMESTIC DRIVEWAY IS < 3m, INFILL WITH CONCRETE TO MATCH. PROVIDE JOINT ALIGNED WITH PROPERTY BOUNDARY TO DELINEATE DRIVEWAYS.
14. PROVIDE WJ ALONG CENTRE LINE WHERE WIDTH > 3m.



DOMESTIC DRIVEWAYS

NOT TO SCALE

Authorised: *[Signature]*

Latest Revision Details

Rev	Amendment	Date
0	BASED ON DRG DS5-01	14/01/19
Drawing No. ACTSD-0701		Revision 0